

MONTROSE CEMETERY

PLAT OF A TYPICAL SIX GRAVE FAMILY UNIT
SHOWING GRAVE SPACES ASSIGNED TO:
NAME.....
ADDRESS.....
DATE ASSIGNED..... BY.....
FOR THE
MONTROSE CEMETERY ASSOCIATION, INC.
MONTROSE, ALABAMA

SQUARE
BLOCK
UNIT
GRAVES

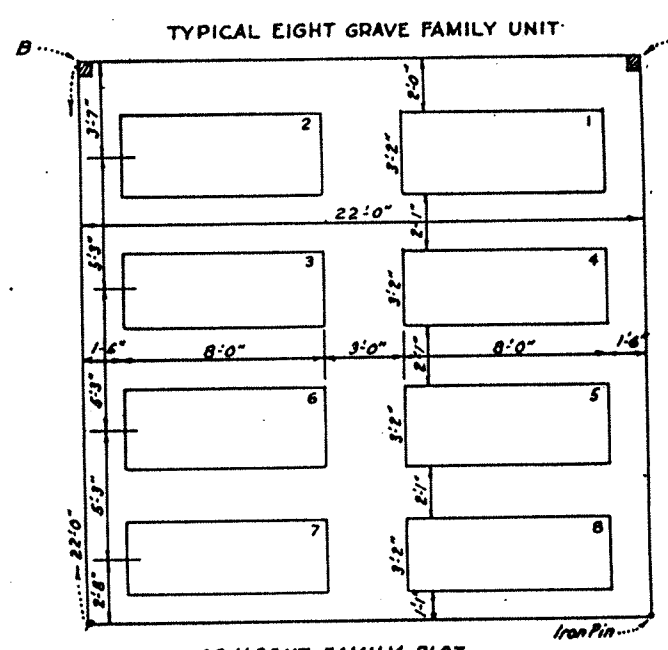
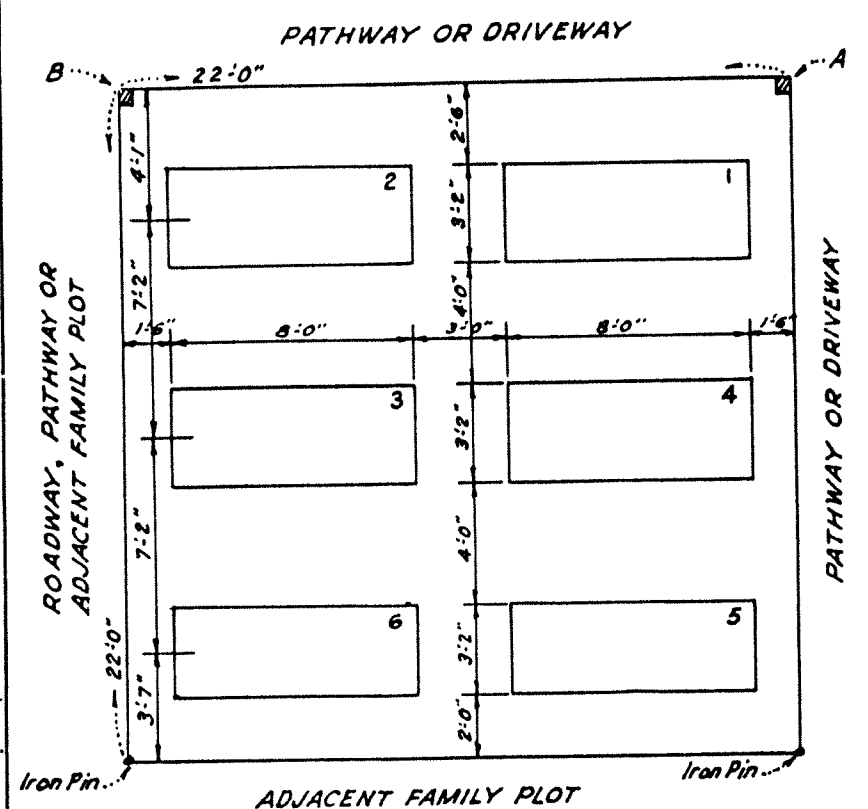

SIBLEY STREET

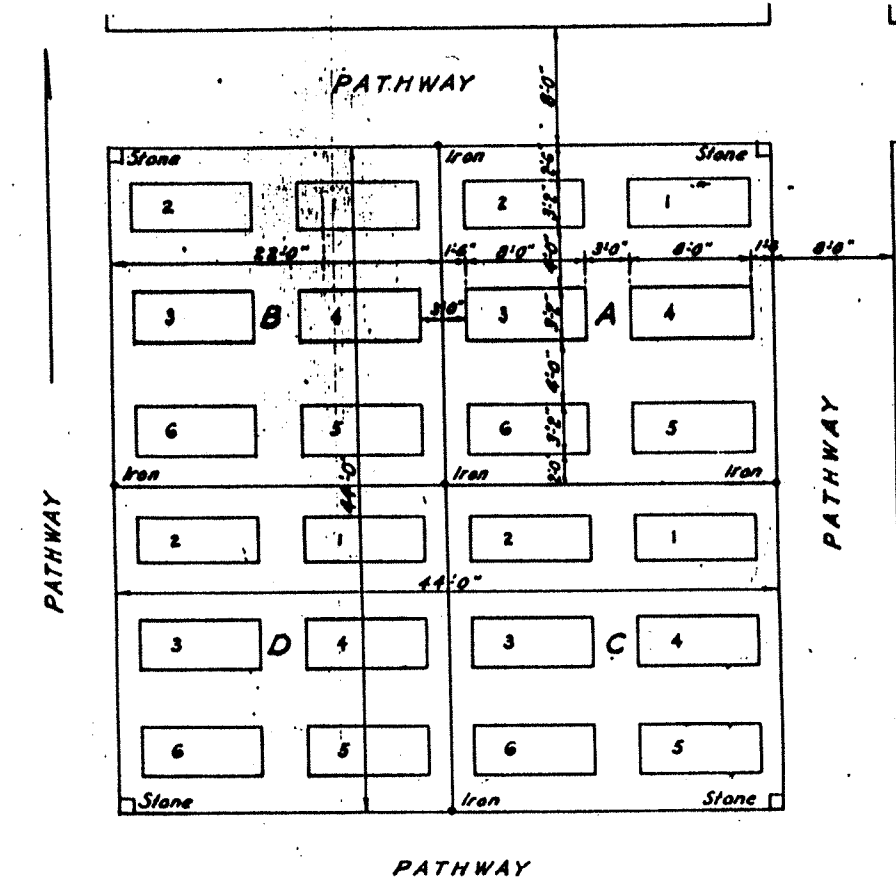

REMARKS: The Cemetery is subdivided into Squares (A-B-C-E) which are bounded by 20 ft. Driveways. The Squares are subdivided into Blocks (1-2-3 etc) which are bounded by 8 ft. Pathways. The Blocks are subdivided into Family Units (A-B-C-D) each containing uniformly numbered grave spaces (either 6 or 8) as shown on the plat that applies. The dimensions shown on the plat are typical and should be followed. The numbering of the graves shall always be in the same geographic position.

